

**SAMSUNG**



# Ducted Air Conditioning

**Duct S2+ and Duct S2 systems**

Working to keep you comfortable all year round



# More than a trusted air conditioning solution

Home is a place full of wonderful moments. At Samsung, we imagine all sorts of innovative ways to improve how your home functions and help it run smoothly – giving you the space you deserve. We are proud to say Samsung products are designed to be intuitive and fit seamlessly into your life.

Samsung air conditioners have been designed with the same passion for innovation and quality that has helped make Samsung one of the world's top electronics producers and one of the Interbrand 2019 Best Global Brands.

Samsung air conditioning systems are held in high esteem, used in apartments, housing, shopping centres, airports, stadiums and hotels around the world. Samsung continues to invest heavily in research and development, performance testing and quality control to deliver quality air conditioning systems to market.



\*Source: Interbrand best Global Brands 2019 rankings.

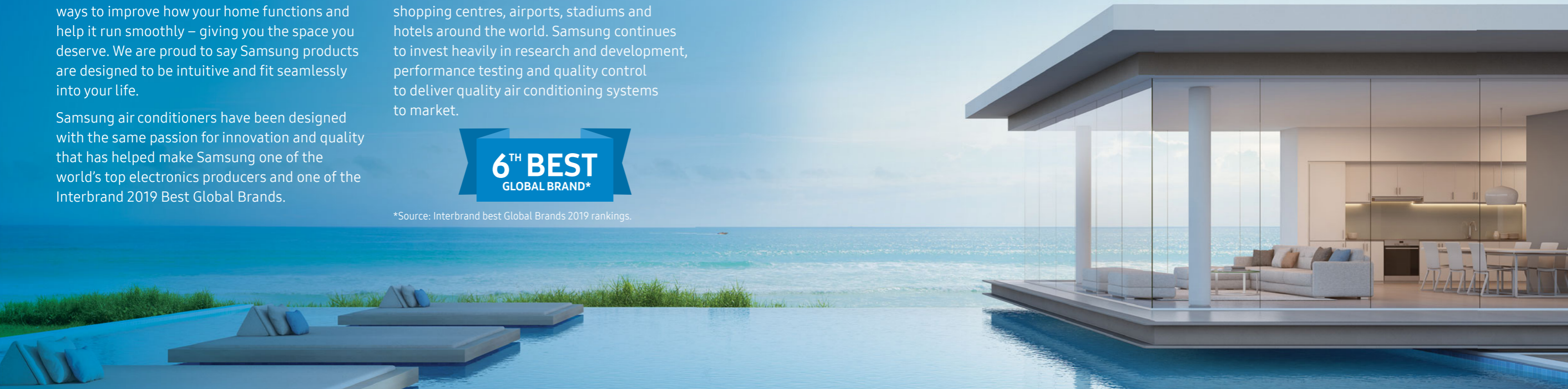

## Working to keep you and your family comfortable all year round

A Samsung inverter reverse cycle ducted air conditioner is designed to enable each room in your home to be cooled or heated by one system. The ducted air conditioning system consists of three main components: an indoor unit, an outdoor unit and a controller.

Ducted systems are relatively unobtrusive as the conditioned air is distributed through ducts hidden in your roof space to outlets in the ceiling of each room.

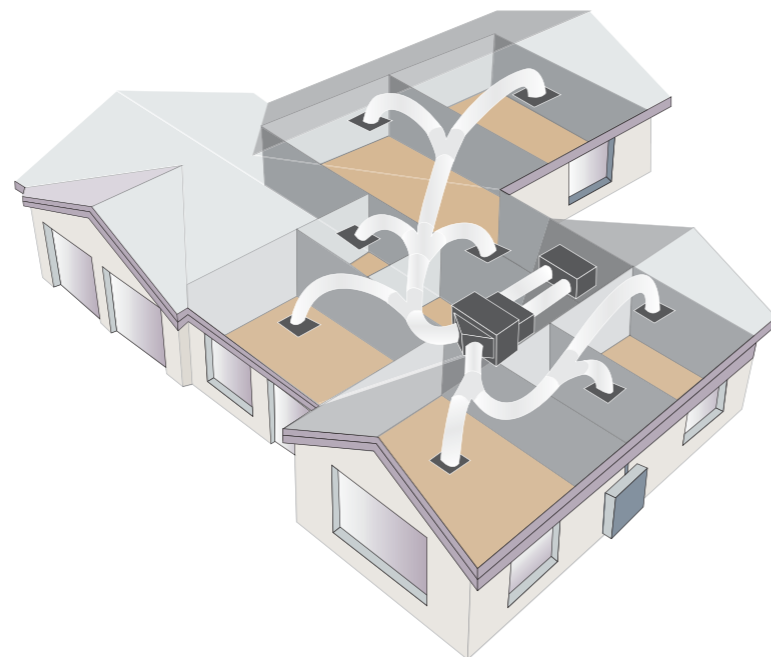

### Controller

A stylish and intuitive controller makes it easy to select your desired temperature and fan speeds. Some controller models also include a number of features such as LCD backlighting and time scheduling.



### Outdoor unit

The outdoor unit contains the Samsung Smart Inverter compressor which circulates refrigerant to the indoor unit and back again. The unit also contains a heat exchanging coil and a fan which blows air across the coil.



### Indoor unit

The indoor unit, hidden from view, also contains a heat exchanging coil that cools the air in your house in cooling mode and warms it in heating mode. A fan then blows the conditioned air through the ducts installed in your roof space to the outlets in the ceiling of each room.





## Thoughtful design

Samsung has added the new eco-friendly R32 refrigerant to its air conditioning range. Refrigerants are an essential part of air conditioning, and it is important to choose a refrigerant that has a low environmental impact. R32 Refrigerant has a lower Global Warming Potential (GWP)\* of 675 compared to R410A GWP of 2,088. R32 is also a zero Ozone Depletion Potential (ODP) refrigerant- which minimises the effects on the ozone layer.

\*Compared to conventional refrigerant R410A.



\* R32 refrigerant is used for 5.2kW to 16kW models.  
 R410A refrigerant is used for 18kW and 20kW models.  
 \*\* Image simulated for illustrative purposes only.

# R32

## Premium Duct S2+

### Works smart to keep you comfortable all year round

#### Powerful airflow

Strong and robust construction brings a maximum of 25% more air-volume than our standard model\* meaning you stay comfortable in all parts of your home.

\*Compared to 12kW model.



**25%**  
 (720 l/s -> 900 l/s)  
 \*Based on 12kW model



#### Fits in small places, covers large spaces

Our Duct S2+ is designed to be small and discrete. Its minimalist modern style creates a sophisticated look, allowing it to fit seamlessly into any home.





# Premium Duct S2+

## Made to fit in more places – perfect for renovations

A splittable type indoor unit can separate the fan and heat exchanger section, making it easier to position into tight roof space – perfect for renovations. Combined with hanging brackets positioned to minimise obstruction, installation has never been this easy.

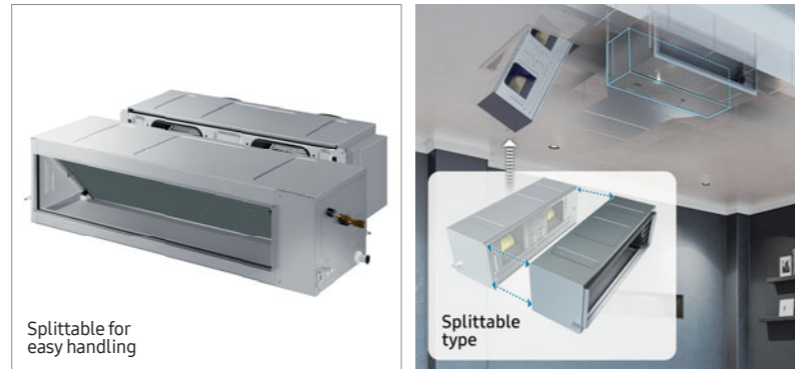

### Peaceful environment

With the indoor unit's low operating noise, you can enjoy comfortable air conditioning with minimal disturbance, while the outdoor unit modulates to meet demand with minimal noise. Even the most sensitive can rest happily with Duct S2+.

### Energy superstar

The Duct S2+ is a highly energy-efficient system. For the equivalent airflow, it uses less energy. This leads to lower running cost meaning you can use your Samsung Ducted system all day long.

# Premium Duct S2+ Made for Australia

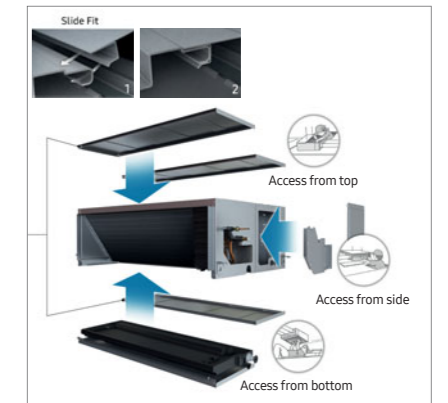

## Easy to install

A light, compact design with a quality finish means the S2+ can easily be manoeuvred into tight installation spaces.

The narrow fan casing section fits in between roof trusses or in between tight gaps.

## Ready to go – return air flange connection

Equipped with a return air flange connection, you can rest assured knowing that the correct return air size is used. This means there is one less item to worry about, saving time and cost.

## Easy maintenance

Most ducted air conditioners are installed in a variety of locations, so they need to be accessed in different ways for maintenance. The Samsung Duct S2+ air conditioner is designed to be accessed from three directions – top, side and bottom – making it easier to maintain wherever it's installed.



# Duct S2

## 5.2kW to 14kW models

### Powerful airflow for fast cooling

Samsung Duct S2 provides powerful airflow, enabling fast cooling for any space. With two fans in the 5.2kW model and three fans in the 7.1kW-14kW models, our Duct S2 system has the power to cool you when you need it the most.



### Lightweight and easy to install

Duct S2 is designed to help make installation easy, with its lightweight and compact indoor unit. Larger capacity models (16kW and above) can be easily separated for handling and maneuvering into tight installation spaces. Indoor units are also low in height, helping the Duct S2 to be installed in narrow roof spaces.



### 3-way service access for easy maintenance

Duct S2 features removable panels on three sides, making maintenance easier than ever before.

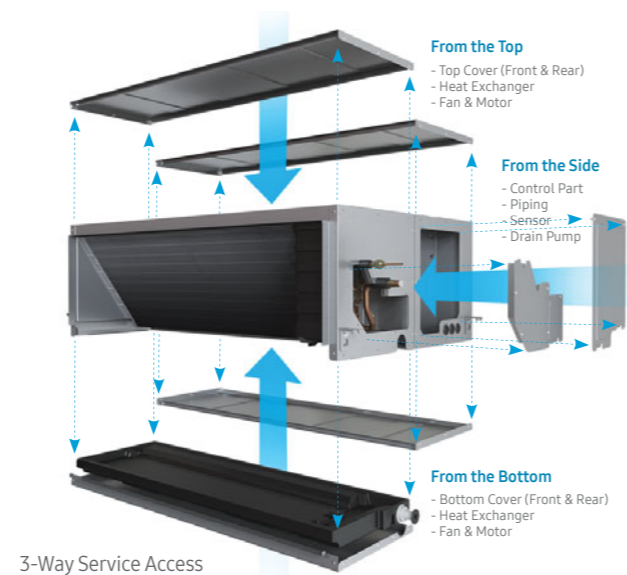

\*Image simulated for illustrative purposes only.

## 16kW to 20kW models

Larger capacity models: 16, 18, and 20kW indoor unit can easily be separated for easy handling and manoeuvring into tight installation spaces.

### Separable for easy handling



### Cutout for roof truss for easy installation





# Samsung Ducted Systems: Duct S2 and Premium Duct S2+



-20°C to 50°C

## This high-performance unit delivers comfort when it's needed

With a Twin BLCD compressor and auto ESP, Samsung's ducted system heats and cools your space in a matter of minutes and maintains optimal air-volume automatically. Able to function in areas with outside ambient conditions between -15°C to 50°C for cooling and -20°C to 24°C for heating, enjoy maximum comfort in any Australian environment.

\*Whilst the unit will keep running up to 50°C for cooling, as the outside temperature rises above 35°C, the cooling capacity will reduce. Similarly for heating, the capacity begins to reduce below 7°C.

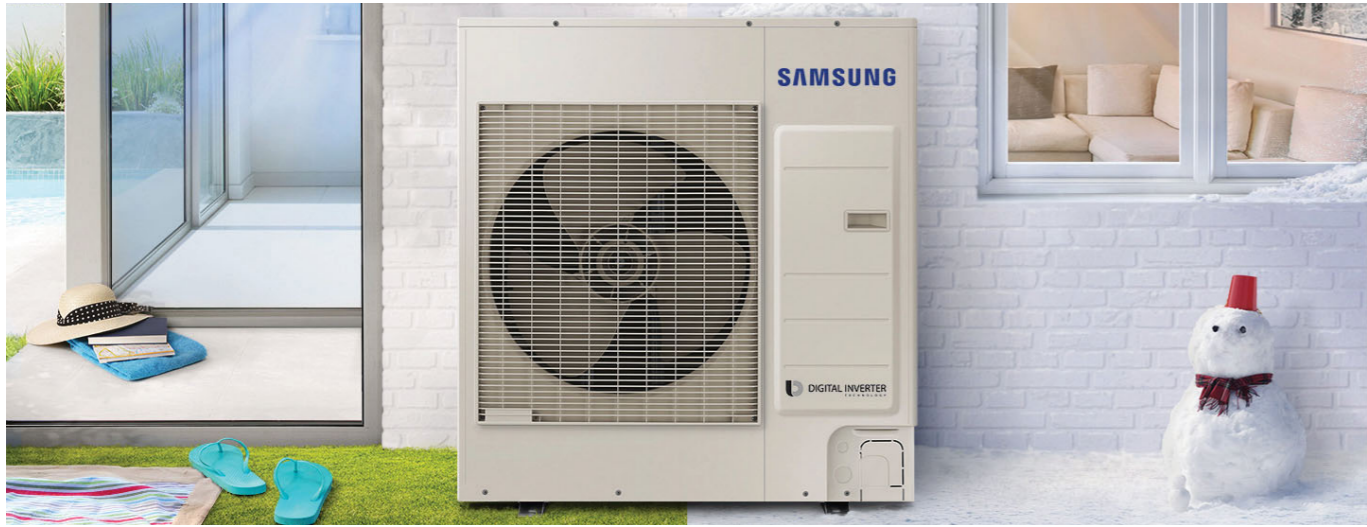

\*Please note that the product image in the picture may be different from the actual one, product size varies depending on model.



## Demand Response Enabled Device (D.R.E.D)

D.R.E.D allows certain energy providers to limit your power consumption during peak demand times to help reduce power strain on the electricity network. Participation may entitle you to rebates from your energy provider, contact your energy provider to find out if it recognises D.R.E.D and for details. All Samsung Duct S systems enable D.R.E.D, with the option of DRM1, DRM2, and DRM3 levels.



# Performance without the cost

## Digital Inverter Technology

Save money with Samsung's energy-efficient Digital Inverter technology. Unlike conventional fixed-speed compressors, which frequently shut off and switch on during operation, the compressor automatically adjusts its speed in response to changes in room temperature and user setting. This technology helps to ensure optimum comfort by maintaining the desired temperature with little fluctuation, at the same time it optimises power usage, reducing energy consumption and reducing operating cost.

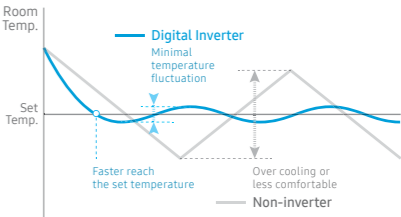



# Premium Duct S2+

1-phase, 220-240V, 50Hz

3-phase, 380-415V, 50Hz



Model Name System	Indoor unit		AC100TNHPKG/SA	AC120TNHPKG/SA	AC140TNHPKG/SA	AC160TNHPKG/SA	AC100TNHPKG/SA	AC120TNHPKG/SA	AC140TNHPKG/SA	AC160TNHPKG/SA
	Outdoor unit		AC100TXAPKG/SA	AC120TXAPKG/SA	AC140TXAPKG/SA	AC160TXAPKG/SA	AC100TXAPNG/SA	AC120TXAPNG/SA	AC140TXAPNG/SA	AC160TXAPNG/SA
Capacity	Cooling (Min/Std/Max)	kW	4.7 / 10.0 / 14.0	5.2 / 12.5 / 16.5	5.5 / 14.0 / 17.5	5.8 / 15.5 / 18.0	4.7 / 10.0 / 14.0	5.2 / 12.5 / 16.5	5.5 / 14.0 / 17.5	5.8 / 15.5 / 18.0
	Heating (Min/Std/Max)	kW	3.6 / 12.5 / 17.0	3.8 / 15.0 / 19.0	4.0 / 16.5 / 19.5	4.2 / 18.0 / 20.0	3.6 / 12.5 / 17.0	3.8 / 15.0 / 19.0	4.0 / 16.5 / 19.5	4.2 / 18.0 / 20.0
Efficiency	Energy grade (Cooling)	EER	3.80	3.60	3.40	3.30	3.80	3.60	3.40	3.30
	Energy grade (Heating)	COP	4.10	3.90	3.80	3.73	4.10	3.90	3.80	3.73
	Energy grade (Cooling)	AEER	3.79	3.60	3.39	3.30	3.79	3.60	3.39	3.30
	Energy grade (Heating)	ACOP	4.09	3.89	3.80	3.72	4.09	3.89	3.80	3.72
Electrical	MCA	A	26.7	35.1	35.9	36.3	18.8	19.2	20.0	20.3
	MFA	A	30.0	40.0	40.0	40.0	18.8	19.2	20.0	20.3
Indoor Unit	Power supply	Φ, #, V, Hz	1-phase, 220-240V, 50Hz							
	Airflow rate (H, M, L)	l/s	800 / 683 / 550	900 / 750 / 600	1,000 / 833 / 650	1,116 / 966 / 800	800 / 683 / 550	900 / 750 / 600	1,000 / 833 / 650	1,116 / 966 / 800
	ESP (L,M,H)	Pa	0 / 49 / 150	0 / 61 / 150	0 / 61 / 150	49 / 60 / 100	0 / 49 / 150	0 / 61 / 150	0 / 61 / 150	49 / 60 / 100
	Sound pressure @ 1.5m (H/L)	dB(A)	42 / 38 / 33	44 / 39 / 34	46 / 41 / 36	49 / 45 / 41	42 / 38 / 33	44 / 39 / 34	46 / 41 / 36	49 / 45 / 41
	Supply air opening (WxH)	mm	1154 x 243							
	Return air opening (WxH)	mm	2 x spigot, each spigot to suit Ø16" (Ø400mm) round flexible duct							
	Net weight	kg	66.5							
	Unit dimensions (WxHxD)	mm	1350 x 360 x 899							
	Drain connection size	mm	OD 32 / ID 25							
	Drain pump (sold separately)		MDP-G075SP (external type), MDP-G075SQ (internal type)							
Outdoor Unit	Power supply	Φ, #, V, Hz	1-phase, 220-240V, 50Hz				3-phase, 380-415V, 50Hz			
	Type		Rotary				Rotary			
	Sound pressure @ 1m (Cool/Heat)	dB(A)	51 / 53	53 / 55	54 / 56	55 / 57	51 / 53	53 / 55	54 / 56	55 / 57
	Sound power (Cooling - High)	dB(A)	68	69	70	71	68	69	70	71
	Net weight	kg	97.5	100.5	100.5	100.5	97.5	100.5	100.5	100.5
Net dimensions (WxHxD)	mm	940 x 1420 x 330	940 x 1420 x 330	940 x 1420 x 330	940 x 1420 x 330	940 x 1420 x 330	940 x 1420 x 330	940 x 1420 x 330	940 x 1420 x 330	
Installation	Liquid pipe	mm, inch	9.52, 3/8"	9.52, 3/8"	9.52, 3/8"	9.52, 3/8"	9.52, 3/8"	9.52, 3/8"	9.52, 3/8"	9.52, 3/8"
	Gas pipe	mm, inch	15.8, 5/8"	15.8, 5/8"	15.8, 5/8"	15.8, 5/8"	15.8, 5/8"	15.8, 5/8"	15.8, 5/8"	15.8, 5/8"
	Max. allowable piping length	m	85	85	85	85	85	85	85	85
	Max. allowable piping height (outdoor above indoor)	m	30	30	30	30	30	30	30	30
	Pre-charged length	m	30	30	30	30	30	30	30	30
Operating Range	Cooling	°C	-15 to 50							
	Heating	°C	-20 to 24							

1. Specification may be subject to change without prior notice

2. Performances are based on the following test conditions:  
Cooling: Indoor temperature 27°C DB, 19°C WB, Outdoor temperature 35°C DB, 24°C WB  
Heating: Indoor temperature 20°C DB, 15°C WB, Outdoor temperature 7°C DB, 6°C WB  
Equivalent refrigerant pipe length 5m, 7.5m (20kW), Level differences 0m

3. Select wire size based on the value of MCA and in accordance of local electrical regulation standards.

4. Sound pressure level is obtained in an anechoic room.

Sound pressure level is a relative value, depending on the distance and acoustic environment.  
Sound pressure level may differ depending on operation condition.  
dB(A) = A-weighted sound pressure level. Reference acoustic pressure 0 dB = 20uPa

5. Sound power level is an absolute value that a sound source generates.  
dB(A) = A-weighted sound power level. Reference power: 1pW. Measured according to ISO 3741.

Please note that product images may be different from the actual one, product size varies depending on model





# DUCT S2

1-phase, 220-240V, 50Hz



Model Name System	Indoor unit		AC052TNHDKG/SA	AC071TNHDKG/SA	AC090TNHDKG/SA	AC100TNHDKG/SA	AC120TNHDKG/SA	AC140TNHDKG/SA	AC160TNHDKG/SA
	Outdoor unit		AC052TXAPKG/SA	AC071TXAPKG/SA	AC090TXAPKG/SA	AC100TXAPKG/SA	AC120TXAPKG/SA	AC140TXAPKG/SA	AC160TXAPKG/SA
Capacity	Refrigerant		R32	R32	R32	R32	R32	R32	R32
	Cooling (Min/Std/Max)	kW	1.30 / 5.20 / 6.50	2.00 / 7.10 / 8.00	3.0 / 8.5 / 11.5	4.3 / 10.0 / 12.0	4.5 / 12.0 / 14.0	4.7 / 14.0 / 16.0	6.2 / 16.0 / 18.0
	Heating (Min/Std/Max)	kW	1.20 / 6.00 / 8.00	1.70 / 8.00 / 9.00	2.8 / 10.0 / 15.5	3.6 / 11.2 / 16.0	3.8 / 14.0 / 19.0	4.0 / 16.0 / 19.5	4.8 / 18.0 / 20.0
Efficiency	Energy grade (Cooling)	EER	3.70	3.21	3.30	3.70	3.40	3.16	3.60
	Energy grade (Heating)	COP	4.00	4.00	3.70	4.10	3.80	3.50	3.85
	Energy grade (Cooling)	AEER	3.68	3.21	3.28	3.69	3.44	3.15	3.6
	Energy grade (Heating)	ACOP	3.99	3.99	3.69	4.09	3.79	3.49	3.84
Electrical	MCA	A	18.8	18.8	26.3	26.7	34.9	35.5	35.1
	MFA	A	20.7	20.7	30	30	40	40	40
Indoor Unit	Power supply	Φ, #, V, Hz	1-phase, 220-240V, 50Hz						
	Airflow rate (H, M, L)	l/s	300 / 233 / 183	400 / 333 / 283	530 / 450 / 370	650 / 550 / 450	720 / 620 / 500	850 / 730 / 600	1120 / 970 / 820
	ESP (L,M,H)	Pa	0 / 39 / 147	0 / 39 / 147	29 / 49 / 147	29 / 49 / 196	29 / 61 / 196	29 / 60 / 196	49 / 61 / 196
	Sound pressure @ 1.5m (H/L)	dB(A)	35 / 27	36 / 28	42 / 37 / 32	42 / 37 / 32	43 / 38 / 33	45 / 40 / 35	43 / 39 / 35
	Supply air opening (WxH)	mm	818 x 220	1168 x 220	1168 x 220	1268 x 270	1268 x 270	1268 x 270	1284 x 360
	Return air opening (WxH)	mm	818 x 220	1168 x 220	1168 x 220	1268 x 270	1268 x 270	1268 x 270	1284 x 360
	Net weight	kg	26.5	34	33.5	43.5	43.5	43.5	75
	Unit dimensions (WxHxD)	mm	850 x 250 x 700	1200 x 250 x 700	1200 x 250 x 700	1300 x 300 x 700	1300 x 300 x 700	1300 x 300 x 700	1350 x 450 x 850
	Drain connection size	mm	OD 32 / ID 25	OD 32 / ID 25	OD 32 / ID 25	OD 32 / ID 25	OD 32 / ID 25	OD 32 / ID 25	OD 32 / ID 25
	Drain pump (sold separately)		MDP-G075SP (external type), MDP-G075SQ (internal type)						
Outdoor Unit	Power supply	Φ, #, V, Hz	1-phase, 220-240V, 50Hz						
	Type		Twin BLDC Rotary	Twin BLDC Rotary	Rotary	Rotary	Rotary	Rotary	Rotary
	Sound pressure @ 1m (Cool/Heat)	dB(A)	49 / 49	50 / 52	51 / 53	51 / 53	53 / 55	54 / 56	55 / 57
	Sound power (Cooling - High)	dB(A)	63	66	68	68	69	70	71
	Net weight	kg	51	51	75	97.5	100.5	100.5	100.5
	Shipping weight	kg	55	55	80	106.5	109.5	109.5	109.5
	Net dimensions (WxHxD)	mm	880 x 798 x 310	880 x 798 x 310	940 x 998 x 330	940 x 1420 x 330	940 x 1420 x 330	940 x 1420 x 330	940 x 1420 x 330
	Shipping dimensions (WxHxD)	mm	1,023 x 896 x 413	1,023 x 896 x 413	995 x 1096 x 426	995 x 1598 x 426	995 x 1598 x 426	995 x 1598 x 426	995 x 1598 x 426
Installation	Liquid pipe		6.35, 1/4"	6.35, 1/4"	9.52, 3/8"	9.52, 3/8"	9.52, 3/8"	9.52, 3/8"	9.52, 3/8"
	Gas pipe		15.8, 5/8"	15.8, 5/8"	15.8, 5/8"	15.8, 5/8"	15.8, 5/8"	15.8, 5/8"	15.8, 5/8"
	Max. allowable piping length	m	50	50	50	85	85	85	85
	Max. allowable piping height (outdoor above indoor)	m	30	30	30	30	30	30	30
	Pre-charged length	m	20	20	30	30	30	30	30
Operating Range	Cooling	°C	-15 to 50	-15 to 50	-15 to 50	-15-50	-15 to 50	-15 to 50	-15 to 50
	Heating	°C	-20 to 24	-20 to 24	-20 to 24	-20-24	-20 to 24	-20 to 24	-20 to 24

1. Specification may be subject to change without prior notice  
 2. Performances are based on the following test conditions:  
 Cooling: Indoor temperature 27°C DB, 19°C WB, Outdoor temperature 35°C DB, 24°C WB  
 Heating: Indoor temperature 20°C DB, 15°C WB, Outdoor temperature 7°C DB, 6°C WB  
 Equivalent refrigerant pipe length 5m, 7.5m (20kW), Level differences 0m  
 3. Select wire size based on the value of MCA and in accordance of local electrical regulation standards.

4. Sound pressure level is obtained in an anechoic room.  
 Sound pressure level is a relative value, depending on the distance and acoustic environment.  
 Sound pressure level may differ depending on operation condition.  
 dBA = A-weighted sound pressure level. Reference acoustic pressure 0 dB = 20uPa  
 5. Sound power level is an absolute value that a sound source generates.  
 dBA = A-weighted sound power level. Reference power: 1pW. Measured according to ISO 3741.

Please note that product images may be different from the actual one, product size varies depending on model





# DUCT S2

3-phase, 380-415V, 50Hz



Model Name System	Indoor unit		AC100TNHDKG/SA	AC120TNHDKG/SA	AC140TNHDKG/SA	AC160TNHFKG/SA	AC180JNHFKH/SA	AC200JNHFKH/SA
	Outdoor unit		AC100TXAPNG/SA	AC120TXAPNG/SA	AC140TXAPNG/SA	AC160TXAPNG/SA	AC180JXAFNH/SA	AC200JXAFNH/SA
Capacity	Refrigerant		R32	R32	R32	R32	R410A	R410A
	Cooling (Min/Std/Max)	kW	4.3 / 10.0 / 12.0	4.5 / 12.0 / 14.0	4.7 / 14.0 / 16.0	6.2 / 16.0 / 18.0	6.0 / 18.0 / 20.0	6.2 / 20.0 / 22.5
	Heating (Min/Std/Max)	kW	3.6 / 11.2 / 16.0	3.8 / 14.0 / 19.0	4.0 / 16.0 / 19.5	4.8 / 18.0 / 20.0	4.8 / 20.0 / 22.5	5.0 / 22.5 / 25.0
Efficiency	Energy grade (Cooling)	EER	3.70	3.40	3.16	3.60	3.40	3.30
	Energy grade (Heating)	COP	4.10	3.80	3.50	3.85	3.70	3.70
	Energy grade (Cooling)	AEER	3.69	3.44	3.15	3.6	NA	NA
	Energy grade (Heating)	ACOP	4.09	3.79	3.49	3.84	NA	NA
Electrical	MCA	A	18.8	19	19.6	19.2	18.6	25
	MFA	A	18.8	19	19.6	19.2	20.5	31.25
Indoor Unit	Power supply	Φ, #, V, Hz	3-phase, 380-415V, 50Hz					
	Airflow rate (H, M, L)	l/s	650 / 550 / 450	720 / 620 / 500	850 / 730 / 600	1120 / 970 / 820	1183 / 1000 / 833	1200 / 1016 / 850
	ESP (L,M,H)	Pa	29 / 49 / 196	29 / 61 / 196	29 / 60 / 196	49 / 61 / 196	49 / 60 / 196	49 / 72 / 196
	Sound pressure @ 1.5m (H/L)	dB(A)	42 / 37 / 32	43 / 38 / 33	45 / 40 / 35	43 / 39 / 35	43 / 39 / 35	44 / 40 / 36
	Supply air opening (WxH)	mm	1268 x 270	1268 x 270	1268 x 270	1284 x 360	1284 x 360	1284 x 360
	Return air opening (WxH)	mm	1268 x 270	1268 x 270	1268 x 270	1284 x 360	1284 x 360	1284 x 360
	Net weight	kg	43.5	43.5	43.5	75	82.5	82.5
	Unit dimensions (WxHxD)	mm	1300 x 300 x 700	1300 x 300 x 700	1300 x 300 x 700	1350 x 450 x 850	1,350 x 450 x 910	1,350 x 450 x 910
	Drain connection size	mm	OD 32 / ID 25	OD 32 / ID 25	OD 32 / ID 25	OD 32 / ID 25	OD 32 / ID 25	OD 32 / ID 25
	Drain pump (sold separately)		MDP-G075SP (external type), MDP-G075SQ (internal type)					
Outdoor Unit	Power supply	Φ, #, V, Hz	3-phase, 380-415V, 50Hz					
	Type		Rotary	Rotary	Rotary	Rotary	Rotary	BLDC Scroll
	Sound pressure @ 1m (Cool/Heat)	dB(A)	51 / 53	53 / 55	54 / 56	55 / 57	55 / 57	57 / 59
	Sound power (Cooling - High)	dB(A)	68	69	70	71	-	-
	Net weight	kg	97.5	99.5	99.5	99.5	107.5	190.0
	Shipping weight	kg	106.5	108.5	108.5	108.5	117.5	195.0
	Net dimensions (WxHxD)	mm	940 x 1420 x 330	940 x 1420 x 330	940 x 1420 x 330	940 x 1420 x 330	940 x 1,420 x 330	880 x 1,695 x 765
	Shipping dimensions (WxHxD)	mm	995 x 1598 x 426	995 x 1598 x 426	995 x 1598 x 426	995 x 1598 x 426	995 x 1,598 x 426	948 x 1,887 x 832
Installation	Liquid pipe		9.52, 3/8"	9.52, 3/8"	9.52, 3/8"	9.52, 3/8"	9.52, 3/8"	9.52, 3/8"
	Gas pipe		15.8, 5/8"	15.8, 5/8"	15.8, 5/8"	15.8, 5/8"	19.05, 3/4"	19.05, 3/4"
	Max. allowable piping length	m	85	85	85	85	75	150
	Max. allowable piping height (outdoor above indoor)	m	30	30	30	30	30	50
	Pre-charged length	m	30	30	30	30	30	30
Operating Range	Cooling	°C	-15~50	-15 to 50	-15 to 50	-15 to 50	-15 to 50	-15 to 50
	Heating	°C	-20~24	-20 to 24	-20 to 24	-20 to 24	-20 to 24	-20 to 24

1. Specification may be subject to change without prior notice  
 2. Performances are based on the following test conditions:  
 Cooling: Indoor temperature 27°C DB, 19°C WB, Outdoor temperature 35°C DB, 24°C WB  
 Heating: Indoor temperature 20°C DB, 15°C WB, Outdoor temperature 7°C DB, 6°C WB  
 Equivalent refrigerant pipe length 5m, 7.5m (20kW), Level differences 0m  
 3. Select wire size based on the value of MCA and in accordance of local electrical regulation standards.

4. Sound pressure level is obtained in an anechoic room.  
 Sound pressure level is a relative value, depending on the distance and acoustic environment.  
 Sound pressure level may differ depending on operation condition.  
 dBA = A-weighted sound pressure level. Reference acoustic pressure 0 dB = 20uPa  
 5. Sound power level is an absolute value that a sound source generates.  
 dBA = A-weighted sound power level. Reference power: 1pW. Measured according to ISO 3741.

Please note that product images may be different from the actual one, product size varies depending on model  
 18kW and 20kW model uses R410A refrigerant



# Controls to meet your needs

(All controllers shown are sold separately)



## MWR-WG00JN UX Wired Controller

- Colour LCD display with backlight
- Intuitive user interface
- Simple navigational control panel
- Current date and time setting
- Programmable yearly scheduling and holiday scheduling
- Energy usage monitoring
- Built-in wireless receiver can be used with AR-EH03E wireless controller
- Built-in room temperature sensor



## MWR-SH11N LED Touch Screen Wired Controller

- Touch screen display with backlight
- Simple functionality control
- Outgoing function; maintains room at preset conditions
- Lock functionality options
- On/off count down timer
- Built-in wireless receiver can be used with AR-EH03E wireless controller
- Built-in room temperature sensor



## MWR-WE13N Standard Wired Controller

- Touch button controller, display with backlight
- Lock functionality options
- Current date and time setting
- Weekly scheduler and exception day setting
- Filter cleaning alert indicator
- Built-in room temperature sensor



## AR-EH03E Wireless Controller

- Simple functionality control
- On/off count down timer
- Filter cleaning alert indicator
- Use with MRK-A10N wireless controller receiver



## MIM-B14 External Contact Interface Module

- Indoor unit on/off control by external contact to key card, push button timer, sensor, etc.
- Output contact to relay for outside air fan connection



Images are for illustrative purposes. Product images may be different to actual product, product size varies depending on model.

# Enjoy Smart Home with an App

The Wi-Fi Kit helps you to control your air conditioner, Samsung TV, appliances and other compatible smart devices. All you need to do is download the Samsung SmartThings App\* to easily check the list of connected compatible devices, name and status.

\*Wi-Fi enabled control requires a wireless router. Wi-Fi enabled control is compatible with selected Android™ and iOS Smartphone and requires Samsung SmartThings App, downloaded from Play store, Galaxy Apps and iTunes Store. Internet connection required. Data charges may apply. Android is a trademark of Google Inc. iOS is a trademark of registered trademark of Cisco in the U.S. and other countries and is used under licence. iTunes is a trademark of Apple Inc., registered in the U.S. and other countries. Products are sold separately. Images and screen displays are for illustrative purposes.

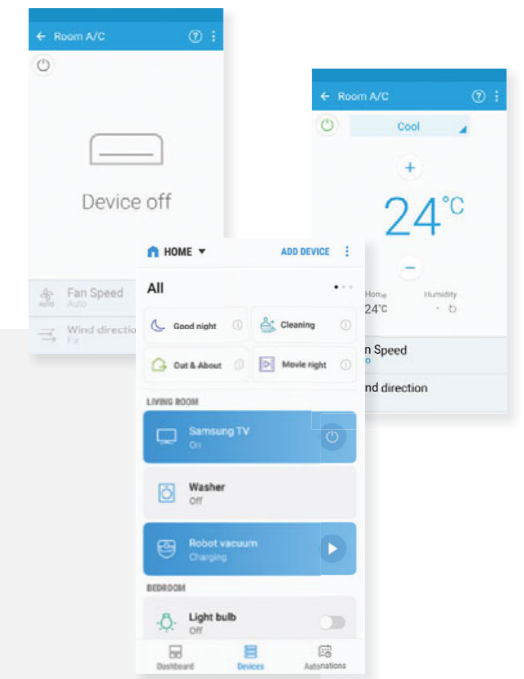
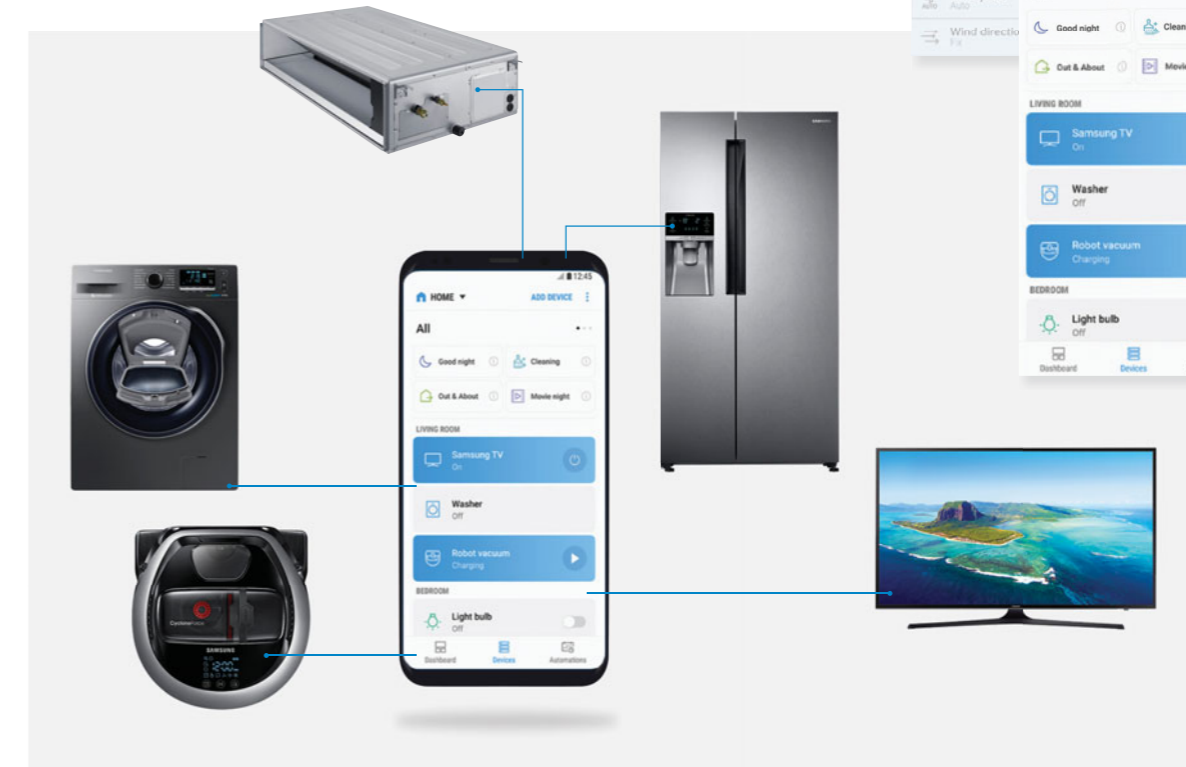

**Wi-Fi Kit (MIM-H04AN)**  
(Sold separately)



# SAMSUNG

**Samsung is committed to after-sales and warranty support, providing you peace of mind**



## **5 year warranty on parts and labour**

We have you covered with Samsung's 5 year parts and labour warranty for residential application of products featured in this brochure. Refer to the warranty card included with your product for full details.\*



## **National Samsung service network**

Our extensive national repairer network and dedicated Service Centres are on hand to support your product. We have extensive spare parts in Australia to ensure we get your air conditioning back up and running fast.



## **MEPS compliant**

All Samsung air conditioners sold in Australia meet Minimum Energy Performance Standards (MEPS) as set by the Australian Government.



## **Product Support Line**

If you have any concerns about your product, simply call 1300 362 603 and our friendly staff will assist with your enquiry and book a service call if required.



## **R32 Refrigerant**

R32 refrigerant is a zero Ozone Depletion Potential (ODP) refrigerant which minimises the effects on the ozone layer.

\* This is in addition to the rights of consumers under consumer guarantees pursuant to the Australian Consumer Law.

**To learn more about  
Samsung Air Conditioners  
Go to [Samsung.com/au/air-conditioners/ducted](https://www.samsung.com/au/air-conditioners/ducted)**

Samsung Electronics Australia Pty Ltd  
ABN 63 002 915 648  
3 Murray Rose Avenue  
Homebush Bay NSW 2127 Australia  
OCTOBER 2020